

### Models

**AC2-B-BV (2-way):** Auxiliary switches for D, B and S actuators.

**AC2-B-BV (3-way):** Auxiliary switches for D, B and S actuators.

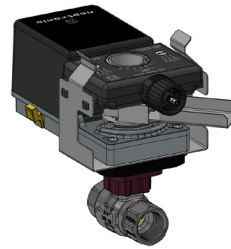

AC2-B-BV (2-way)

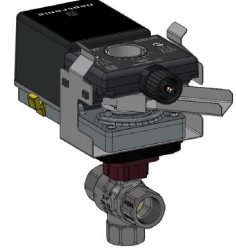

AC2-B-BV (3-way)

### Technical Specification

Description	AC2-B-BV (Siral)
Actuator Compatibility	Neptronic D, B and S series actuators
Power Supply	125VAC, 5A Resistive or 250VAC, 3A Resistive
Electrical Connection	Cable 39.5" (1m), 6 x 18AWG, FT1 with ½" conduit connector
Purpose and Action of Control	Type 1 operating control
Construction of Control	Independently mounted, accessory
Polution Degree	2
Impulse Voltage	4000V

### Dimensions

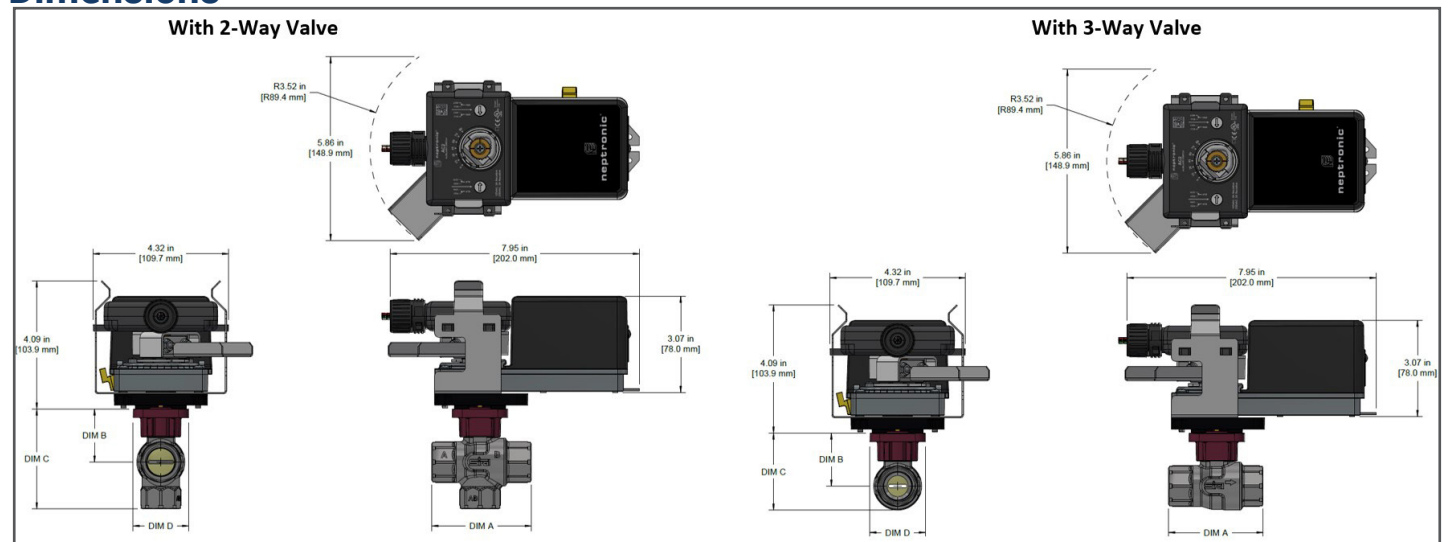

Valve Size	Valve Type	Cv	Kv	Dim A	Dim B	Dim C	Dim D
1/2" [DN10]	2-way	0.3 to 1.9	0.3 to 1.6	2.38" [61mm]	1.53" [39mm]	2.05" [52mm]	1.78" [45mm]
	3-way			2.44" [62mm]		2.75" [70mm]	
1/2" [DN10]	2-way	3.0 to 7.4	2.5 to 6.4	2.66" [68mm]	1.53" [39mm]	2.13" [54mm]	1.78" [45mm]
	3-way			2.76" [70mm]		2.85" [72mm]	
3/4" [DN20]	2-way	4.7 to 14.0	4.0 to 12.0	3.01" [77mm]	1.69" [43mm]	2.46" [62mm]	1.78" [45mm]
	3-way			3.17" [81mm]		3.19" [81mm]	
1" [DN25]	2-way	7.4 to 19.0	6.4 to 16.0	3.78" [96mm]	1.88" [48mm]	2.82" [72mm]	1.88" [48mm]
	3-way			3.80" [97mm]		4.27" [108mm]	
1-1/4" [DN32]	2-way	10.0 to 35.0	8.6 to 30.0	4.15" [106mm]	2.20" [56mm]	3.41" [87mm]	2.4" [61mm]
	3-way			4.35" [111mm]		4.95" [126mm]	
1-1/2" [DN40]	2-way	19.0 to 35.0	16.0 to 32.0	4.39" [116mm]	2.20" [56mm]	3.41" [87mm]	2.4" [61mm]
	3-way					4.95" [126mm]	

## Wiring Diagram

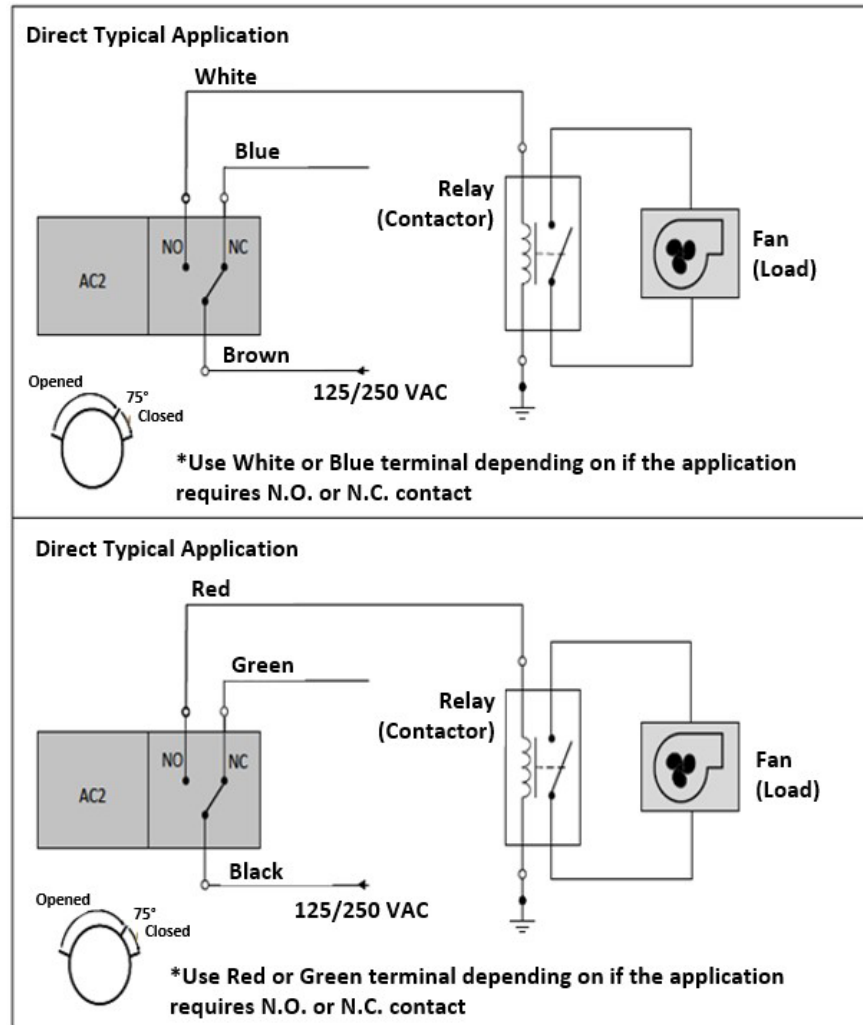

*The auxiliary switch comes factory preset: 10° - 80°*

## Mounting Instruction

Before beginning installation, ensure to set the actuator at a 45° position.

1. Begin by placing the brass shaft (2) onto the top of the 2-way valve (3) and secure it in place using 1x M4-0.7 pan head screw.

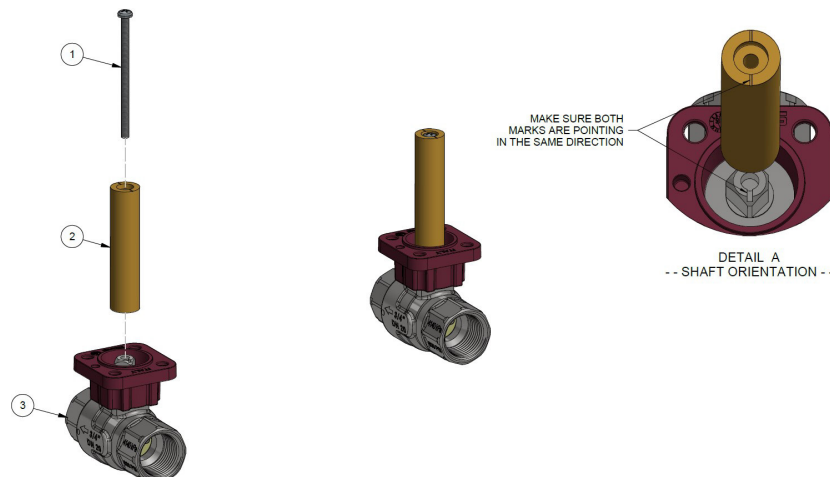

- Using the 2x 8-32 hex nuts (8) and 2x #8-32 pan head phillips screws (4), secure the BB bracket (7) and the AC2 bracket (6) onto the actuator (5). Using 2x nuts, secure the BB handle (9) onto the actuator (5).

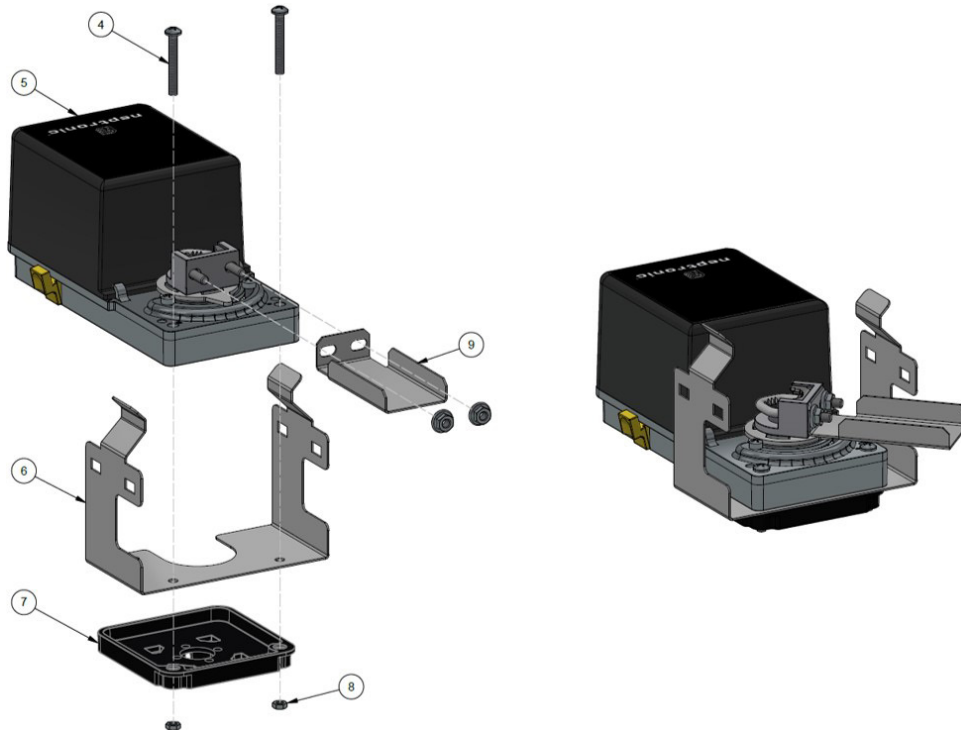

- Insert the brass shaft assembly from step 1 into the actuator assembly from step 2. Ensure that the orientation of the valve and actuators are correct.

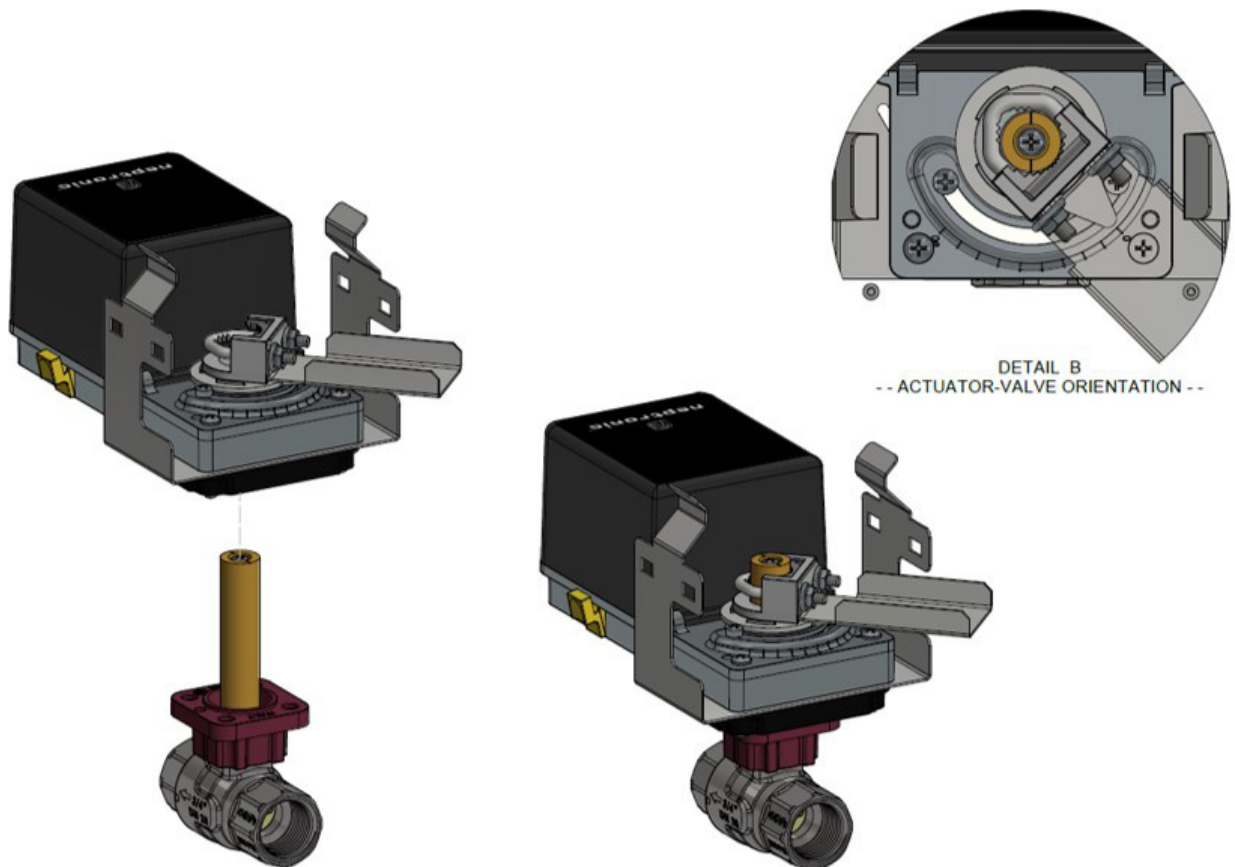

- Attach the AC2 (10) onto the brass shaft assembly and ensure that the AC2 is properly snapped in place.

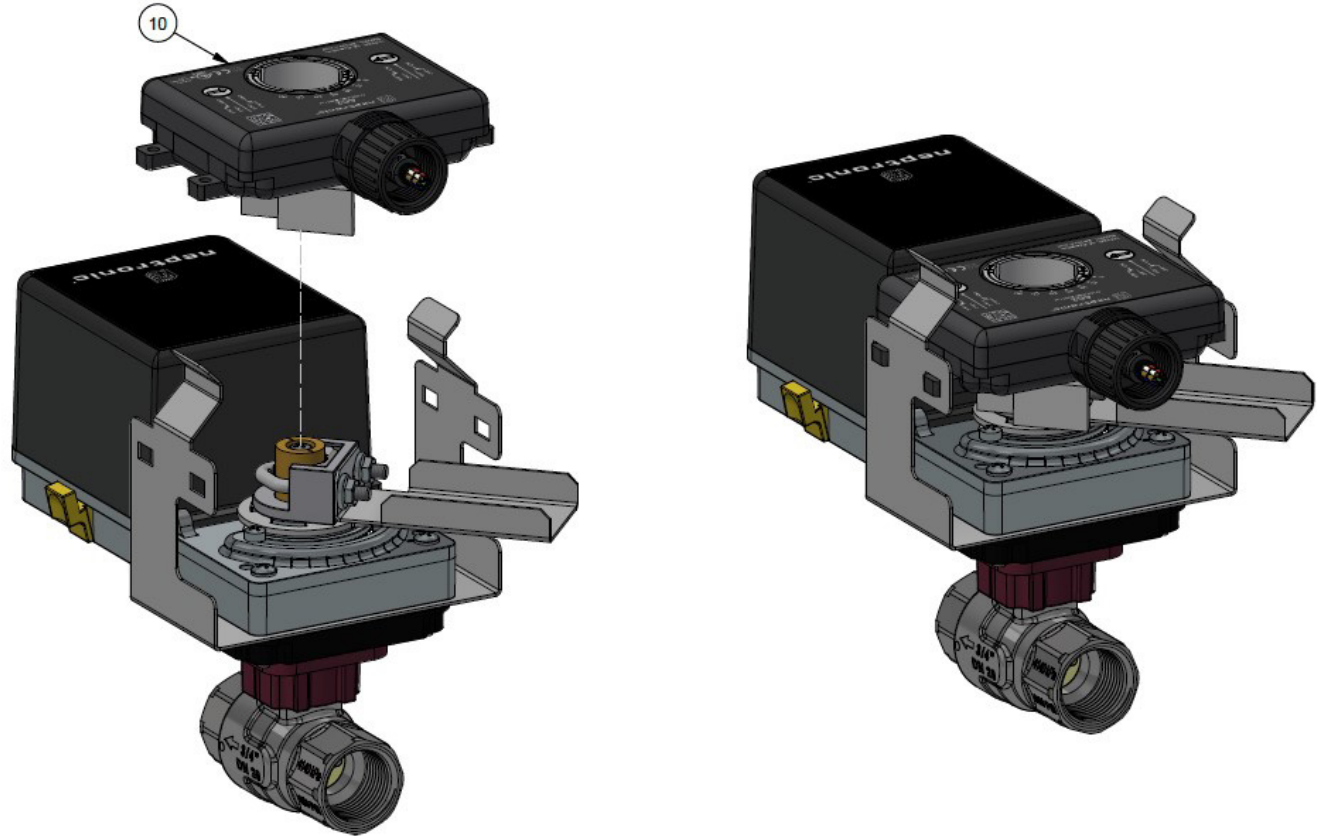

## Actuator Positioning

- Turn the dial on the auxiliary switch to the desired position for the actuator lower contact.
- Using a flathead screwdriver, turn the left arrow on the auxiliary switch so that the arrowhead is aligned with the arrow on the wiring diagram.

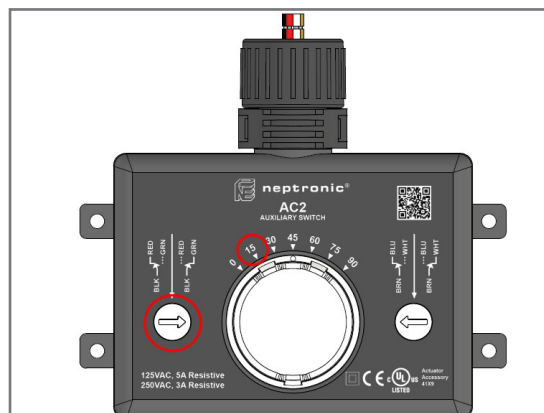

15° Position

- Turn the dial on the auxiliary switch to the desired position for the actuator upper contact.
- Using a flathead screwdriver, turn the right arrow on the auxiliary switch so that the arrowhead is aligned with the arrow on the wiring diagram.



Recycling at end of life: please return this product to your Neptronic local distributor for recycling. If you need to find the nearest Neptronic authorized distributor, please consult [www.neptronic.com](http://www.neptronic.com).